

Name and Post Office Address of Grantor: Westminster Company
P. O. Box 16449
Greenville, S. C. 29602

Toll Line or Exchange Line tributary to: Woodstream Apartments
Greenville, S. C.

The Property is bounded where the line enters and leaves this property by the property of:
Highway 81 on the North
Greenville County School on the East
DIST.

Authority: P-43619 Classification: R45C
 Area: South Carolina

Approved: _____
 Title: District Manager-Distribution

TAX MAP 248
BLOCK 2

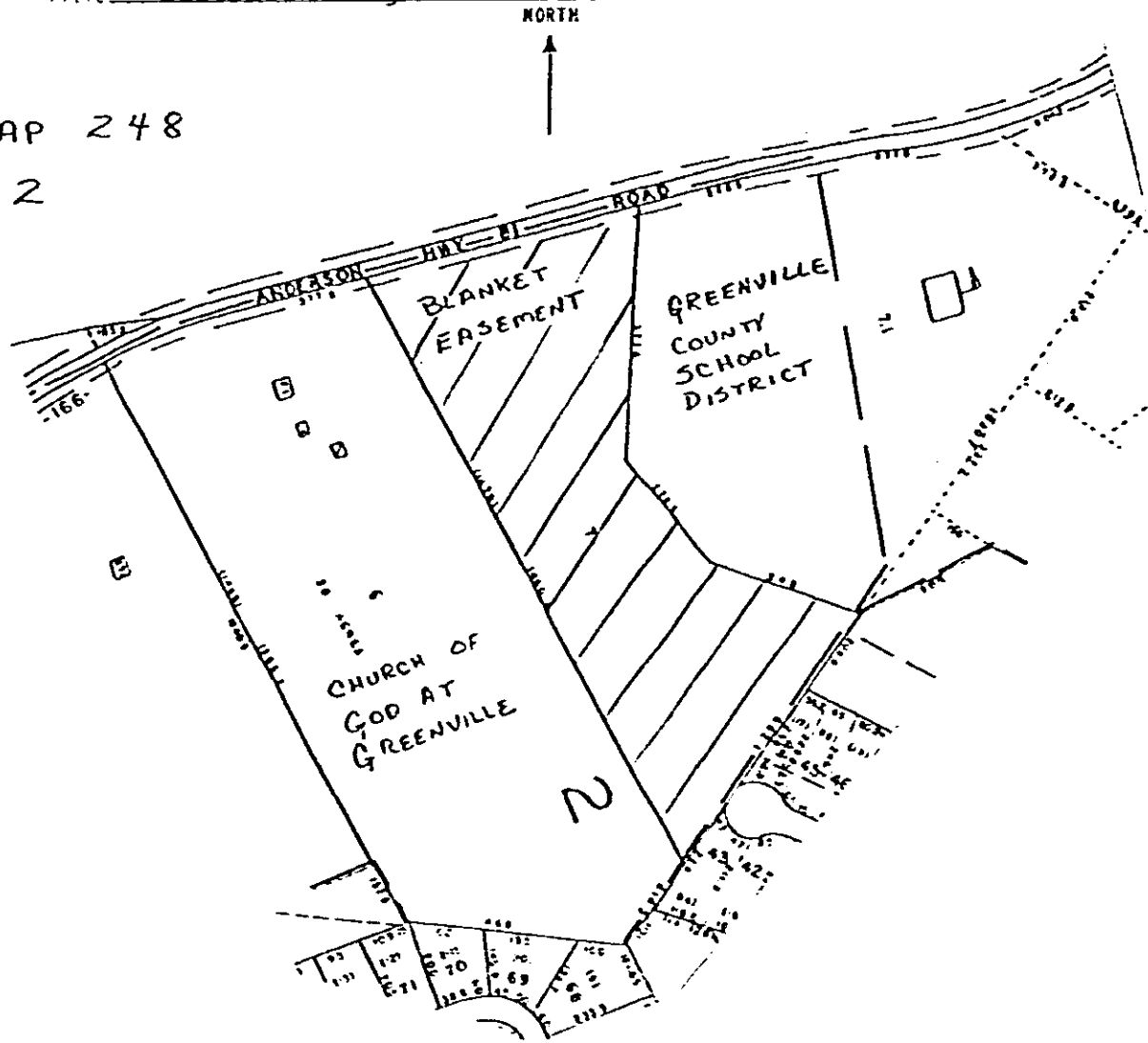

RECORDED MAY 12 1981

at 12:19 P.M.

31530

4328 RV-2

5
9
00
0.